

Shearwood Road, Peatmoor, SN5 5DL

Asking Price £115,000

- New to the Market
- Two Bedrooms
- No Onward Chain
- Sought After Location
- First Floor Apartment
- Bathroom Suite
- Ideal Investment Property
- Living Room/Diner
- Secured Parking Area
- Perfect First Time Buy

Ridgeway are delighted to offer the market a well positioned Two Bedroom First Floor Apartment that benefits from being sold with No Onward Chain and is situated within the much sought after area of Peatmoor, Swindon. The accommodation comprises of; Entrance Hallway, Living Room/Diner, Kitchen with White-Goods, Two Bedrooms and Bathroom Suite. This property further benefits a Secured Parking Area. No Onward Chain.

EPC Rating- C
Council Tax Band- C
Heating Type- Gas Central Heating
Leasehold

974 Years Remaining
Approx £2032.00 Service Charge Per Year (12-Month Period)
£143.75 Ground Rent Per Year





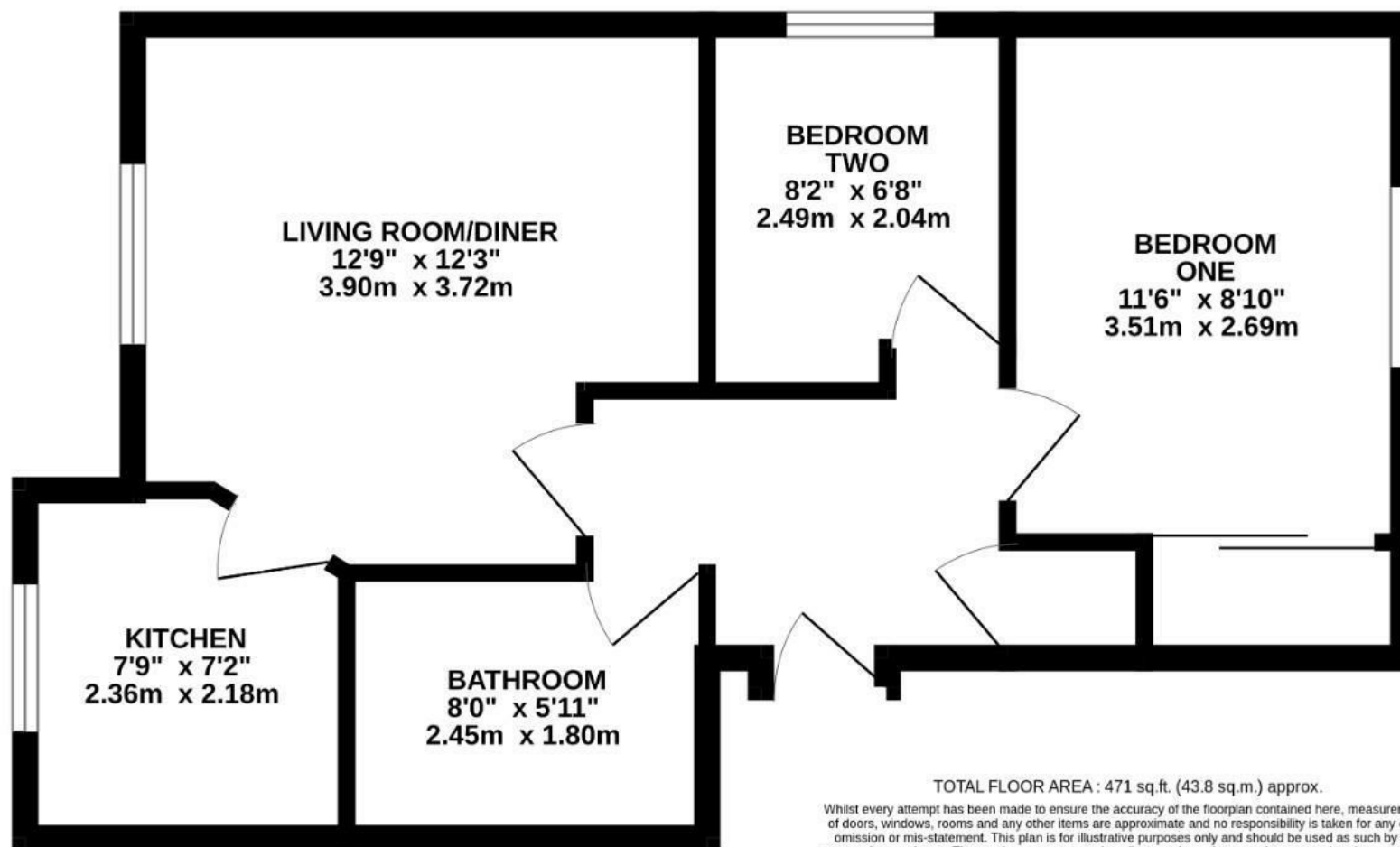

TOTAL FLOOR AREA : 471 sq.ft. (43.8 sq.m.) approx.

Whilst every attempt has been made to ensure the accuracy of the floorplan contained here, measurements of doors, windows, rooms and any other items are approximate and no responsibility is taken for any error, omission or mis-statement. This plan is for illustrative purposes only and should be used as such by any prospective purchaser. The services, systems and appliances shown have not been tested and no guarantee as to their operability or efficiency can be given.

Made with MetroPix ©2024